

# BLUE MOUNTAIN

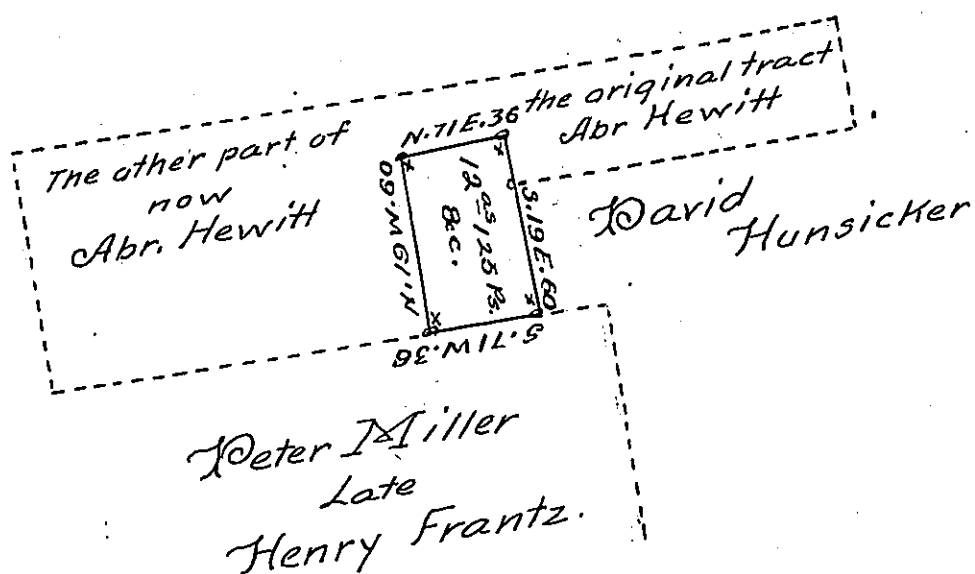

DRAFT of a tract of woodland situate at the foot of the Blue Mountain in Heidelberg township, Lehigh County, containing Twelve acres, one hundred and twenty five perches and allowance of six per cent. for roads &c. Surveyed for Levi Hawk; the fourth day of Dec. A. D. 1872, being a part of a larger tract of One hundred acres and allowance originally surveyed in pursuance of a Warrant granted to Henry German, dated the 12<sup>th</sup> day of January A. D. 1821.

Geo. Blank C. S.

To R. B. Beath Esq.  
Surveyor General.

IN TESTIMONY that the above is a copy of the original remaining on file in the Department of Internal Affairs of Pennsylvania, made conformably to an Act of Assembly approved the 16th day of February, 1833, I have hereunto set my Hand and caused the Seal of said Department to be affixed at Harrisburg, this Twenty Seventh day of February 1905

*Isaac D. Brown*  
Secretary of Internal Affairs.